



**Connecticut Department of Energy and Environmental Protection License\***

**Certificate of Permission**

**Licensee(s):** State of Connecticut  
Department of Energy &  
Environmental Protection, State  
Parks Division

---

**Licensee Address(s):** 79 Elm Street  
Hartford, CT 06106

---

**License Number(s):** 202308901-COP

---

**Municipality:** Town of Haddam

---

**Project Description:** Pier replacement for public fishing access

---

**Project Address/Location:** Eagle Landing State Park, 14 Little Meadow Road, Haddam, CT  
06438

---

**Waters:** Connecticut River

---

**Authorizing CT Statute(s)  
and/or Federal Law:** CGS Section 22a-28 to 35; CGS Section 22a-359 to 363g

---

**Applicable Regulations of  
CT State Agencies:** 22a-30-1 to 17

---

**Agency Contact:** Land & Water Resources Division,  
Bureau of Water Protection & Land Reuse, 860-424-3019

---

**License Expiration:** Five (5) years from the date of issuance of this license.

---

**Project Site Plan Set:** *Eagle Landing Fishing Pier Reconstruction for Mitigation," 11  
sheets, prepared by Hardesty & Hanover Engineering, LLC and  
Amtrak Office of Chief Engineer Structures, dated October 13,  
2023.*

---

\*Connecticut’s Uniform Administrative Procedure Act defines License to include, “the whole or part of any agency permit, certificate, approval, registration, charter or similar form of permission required by law . . .”

**License Enclosures:** LWRD General Conditions; LWRD Compliance Certification Form; LWRD Work Commencement Form; NDDDB (Natural Diversity Database) Determination Letter No. 202305135; Site Plan Set

---

**Authorized Activities:**

The Licensee is hereby authorized to conduct the following work as described in application # 202308901 and as depicted on any site plan sheets / sets cited herein:

1. Temporarily install turbidity curtains, crane mats (as needed), and three (3) barges for construction and material storage, per site plan sheets EL-01, EL-03 and STG-1;
2. Remove existing ramp-supporting fill below CJL and 10' long timber bulkhead per site plan sheet EL-01;
3. Remove derelict 4-pile timber dolphin approximately 25' south of southernmost edge of existing pier head;
4. Remove existing T-shaped pier consisting of a 66' long x 9' wide fixed pier arranged perpendicular to the shore and a 98' long and 9' wide timber pierhead, and associated piles in full or by cutting at a depth of two (2) feet below the mudline per site plan sheet EL-01;
5. Install new timber piles approximately three (3) feet north from existing pile locations and construct new fishing pier to existing pier dimensions: a 66' long by 9' wide fixed pier with 98' long by 9' wide timber pierhead per plan sheets EL-02, EL-05;
6. Replace existing ramp-supporting fill (of which a portion exists below the Coastal Jurisdiction Limit), per plan sheets EL-02 and EL-05;
7. Replace existing 10' long timber bulkhead in-kind and in-place per plan sheets EL-02 and STG-1; and
8. Restore temporarily impacted tidal wetland vegetation, as applicable per License Condition No. 4, herein.

***Failure to comply with the terms and conditions of this license shall subject the Licensee and / or the Licensee's contractor(s) to enforcement actions and penalties as provided by law.***

**This license is subject to the following Terms and Conditions:**

1. **License Enclosure(s) and Conditions.** The Licensee shall comply with all applicable terms and conditions as may be stipulated within the License Enclosure(s) listed above.
2. **Time-of-Year Restrictions. Fisheries Protections.** Unconfined in-water excavation, dredging, filling or removal of debris or other material is prohibited between June 1<sup>st</sup> and September 30<sup>th</sup>, inclusive, of any year to protect fisheries resources in the area unless otherwise authorized in writing by the Commissioner.

3. **Pile Driving. Fisheries Protection.** The Licensee is *prohibited* from pile driving activities below mean high water during the period April 1<sup>st</sup> to June 30<sup>th</sup>, inclusive, to protect migratory fisheries' resources, unless otherwise authorized in writing by the Commissioner.
  - a. During the warmer period within July 1<sup>st</sup> to October 1<sup>st</sup>, inclusive, the Licensee shall use a vibratory hammer to prevent acoustical injury to Atlantic and shortnose sturgeon. Such vibratory equipment is preferred at any time.
  - b. If pile driving with an impact hammer between October 2nd and March 31st, inclusive, the Licensee shall utilize a soft start. A soft start is defined as a low-energy start-up, building over a period of 20-40 minutes to provide fish time to leave the area.
4. **NDDB Species Protections** Per NDDB Determination Letter No. 202305135, attached herein, the Licensee shall submit Habitat Management Plan(s) for identified species' protections to the Commissioner for review and approval at least four (4) weeks (28 days by date) prior to work commencement. The Licensee shall comply with all protection measures in accordance with the approved Habitat Management Plan(s) and NDDB Determination Letter No. 202305135, herein.
5. **Tidal Vegetation Monitoring, Reporting, and Restoration.** If temporary impacts to tidal wetlands occur, the Licensee shall monitor the impacted tidal wetland area(s) annually during the growing season (April 1 - September 30), beginning with the first growing season following construction activities. Following monitoring, the Licensee shall submit a Tidal Wetland Vegetation Monitoring Report to the Commissioner no later than December 15 of each monitoring year. Annual monitoring and reporting shall continue until the temporarily impacted wetland area is shown to be restored to pre-construction conditions. The monitoring report shall contain photos and a quantitative assessment of percent aerial vegetative coverage, change in coverage from pre-construction levels, and upon review, unless otherwise stated by the Commissioner, may be subject to future tidal wetland replanting and/or restoration conditions.

Issued under the authority of the Commissioner of Energy and Environmental Protection on:

February 23, 2024

\_\_\_\_\_  
Date



\_\_\_\_\_  
Brian P. Thompson  
Division Director  
Land & Water Resources Division

## **LWRD General Conditions**

- 1. Land Record Filing (for Structures Dredging & Fill, Tidal Wetlands, Certificate of Permission, and Long Island Sound General Permit Licenses only).** The Licensee shall file the Land Record Filing on the land records of the municipality in which the subject property is located not later than thirty (30) days after license issuance pursuant to Connecticut General Statutes (CGS) Section 22a-363g. A copy of the Notice with a stamp or other such proof of filing with the municipality shall be submitted to [DEEP.LWRDRegulatory@ct.gov](mailto:DEEP.LWRDRegulatory@ct.gov) no later than sixty (60) days after license issuance. If a Land Record Filing form is not enclosed and the work site is not associated with an upland property, no filing is required.
- 2. Contractor Notification.** The Licensee shall give a copy of the license and its attachments to the contractor(s) who will be carrying out the authorized activities prior to the start of construction and shall receive a written receipt for such copy, signed and dated by such contractor(s). The Licensee's contractor(s) shall conduct all operations at the site in full compliance with the license and, to the extent provided by law, may be held liable for any violation of the terms and conditions of the license. At the work site, the contractor(s) shall, whenever work is being performed, have on site and make available for inspection a copy of the license and the authorized plans.
- 3. Work Commencement<sup>1</sup>.** Not later than two (2) weeks prior to the commencement of any work authorized herein, the Licensee shall submit to [DEEP.LWRDRegulatory@ct.gov](mailto:DEEP.LWRDRegulatory@ct.gov), on the Work Commencement Form attached hereto, the name(s) and address(es) of all contractor(s) employed to conduct such work and the expected date for commencement and completion of such work, if any.
  - For water diversion activities authorized pursuant to 22a-377(c)-1 of the Regulations of Connecticut State Agencies, the Licensee shall also notify the Commissioner in writing two weeks prior to initiating the authorized diversion.
  - For emergency activities authorized pursuant Connecticut General Statutes Section 22a-6k, the Licensee shall notify the Commissioner, in writing, of activity commencement at least one (1) day prior to construction and of activity completion no later than five (5) days after conclusion.
- 4. For Coastal Licenses Only - License Notice.** The Licensee shall post the first page of the License in a conspicuous place at the work area while the work authorized therein is undertaken.
- 5. Unauthorized Activities.** Except as specifically authorized, no equipment or material, including but not limited to, fill, construction materials, excavated material or debris, shall be

---

<sup>1</sup> The Work Commencement condition and the need for a Work Commencement Form is not applicable to Flood Management Certification approvals.



deposited, placed or stored in any wetland or watercourse on or off-site. The Licensee may not conduct work within wetlands or watercourses other than as specifically authorized, unless otherwise authorized in writing by the Commissioner. Tidal wetlands means “wetland” as defined by section 22a-29 and “freshwater wetlands and watercourses” means “wetlands” and “watercourses” as defined by section 22a-38.

6. **Management of Materials.** Any materials removed from the site shall be managed in accordance with all federal, state, and local requirements, including Chapter 446K Water Pollution Control, Chapter 445 Hazardous Waste, and Chapter 446d Solid Waste of the Connecticut General Statutes.
7. **Unconfined Instream Work.** Unless otherwise noted in a condition of the license, the following conditions apply to projects in non-coastal waters:
  - Unconfined instream work is limited to the period June 1 through September 30.
  - Confinement of a work area by cofferdam techniques using sand bag placement, sheet pile installation (vibratory method only), portadam, or similar confinement devices is allowed any time of the year. The removal of such confinement devices is allowed any time of the year.
  - Once a work area has been confined, in-water work within the confined area is allowed any time of the year.
  - The confinement technique used shall completely isolate and protect the confined area from all flowing water. The use of silt boom/curtain or similar technique as a means for confinement is prohibited.
8. **For State Actions Only - Material or Equipment Storage in the Floodplain.** Unless approved by a Flood Management Exemption, the storage of any materials at the site which are buoyant, hazardous, flammable, explosive, soluble, expansive, radioactive, or which could in the event of a flood be injurious to human, animal or plant life, below the elevation of the five-hundred (500) year flood is prohibited. Any other material or equipment stored at the site below said elevation by the Licensee or the Licensee's contractor must be firmly anchored, restrained or enclosed to prevent flotation. The quantity of fuel stored below such elevation for equipment used at the site shall not exceed the quantity of fuel that is expected to be used by such equipment in one day. In accordance with the licensee's Flood Contingency Plan, the Licensee shall remove equipment and materials from the floodplain during periods when flood warnings have been issued or are anticipated by a responsible federal, state or local agency. It shall be the Licensee's responsibility to obtain such warnings when flooding is anticipated.
9. **Temporary Hydraulic Facilities for Water Handling.** If not reviewed and approved as a part of the license application, temporary hydraulic facilities shall be designed by a qualified professional and in accordance with the *Connecticut Guidelines for Soil Erosion and Sediment Control*, the *2004 Connecticut Stormwater Quality Manual*, or the *Department of Transportation's ConnDOT Drainage Manual*, as applicable. Temporary hydraulic facilities may include channels, culverts or bridges which are required for haul roads, channel relocations, culvert installations, bridge construction, temporary roads, or detours.

- 10. Excavated Materials.** Unless otherwise authorized, all excavated material shall be staged and managed in a manner which prevents additional impacts to wetlands and watercourses.
- 11. Best Management Practices.** The Licensee shall not cause or allow pollution of any wetlands or watercourses, including pollution resulting from sedimentation and erosion. In constructing or maintaining any authorized structure or facility or conducting any authorized activity, or in removing any such structure or facility, the Licensee shall employ best management practices to control storm water discharges, to prevent erosion and sedimentation, and to otherwise prevent pollution of wetlands and other waters of the State. For purposes of the license, “pollution” means “pollution” as that term is defined by CGS section 22a-423. Best Management Practices include, but are not limited, to practices identified in the *Connecticut Guidelines for Soil Erosion and Sediment Control* as revised, *2004 Connecticut Stormwater Quality Manual*, Department of Transportation’s *ConnDOT Drainage Manual* as revised, and the Department of Transportation Standard Specifications as revised.
- 12. In-Water Work Vessel Staging and Storage. (for Structures Dredging & Fill, Tidal Wetlands, Certificate of Permission, and Long Island Sound General Permit Licenses only).** For any barge, vessel, skiff or floating work platform (“work vessels”) utilized in the execution of the work authorized herein, the Licensee shall ensure that such work vessels:
- do not rest on, or come in contact with, the substrate at any time, unless specifically authorized in the license.
  - are not stored over intertidal flats, submerged aquatic vegetation or tidal wetland vegetation or in a location that interferes with navigation. In the event any work vessel is grounded, no dragging or prop dredging shall occur to free it.
- 13. Work Site Restoration.** Upon completion of any authorized work, the Licensee shall restore all areas impacted by construction, or used as a staging area or accessway in connection with such work, to their condition prior to the commencement of such work.
- 14. Inspection.** The Licensee shall allow any representative of the Commissioner to inspect the project location at reasonable times to ensure that work is being or has been conducted in accordance with the terms and conditions of this license.
- 15. Change of Use. (Applies only if a use is specified within the License “Project Description”)**
- a. The work specified in the license is authorized solely for the purpose set forth in the license. No change in purpose or use of the authorized work or facilities as set forth in the license may occur without the prior written approval of the Commissioner. The Licensee shall, prior to undertaking or allowing any change in use or purpose from that which is authorized by this license, request permission from the Commissioner for such change. Said request shall be in writing and shall describe the proposed change and the reason for the change.
  - b. A change in the form of ownership of any structure authorized herein from a rental/lease commercial marina to a wholly-owned common interest community or dockominium may constitute a change in purpose as specified in paragraph (a) above.
- 16. De Minimis Alteration.** The Licensee shall not deviate from the authorized activity without

prior written approval from the Commissioner. The Licensee may request a de minimis change to any authorized structure, facility, or activity. A de minimis alteration means a change in the authorized design, construction or operation that individually and cumulatively has minimal additional environmental impact and does not substantively alter the project as authorized.

- For diversion activities authorized pursuant to 22a-377(c)-2 of the Regulations of Connecticut State Agencies, a de minimis alteration means an alteration which does not significantly increase the quantity of water diverted or significantly change the capacity to divert water.

**17. Extension Request.** The Licensee may request an extension of the license expiration date. Such request shall be in writing and shall be submitted to [DEEP.LWRDRegulatory@ct.gov](mailto:DEEP.LWRDRegulatory@ct.gov) at least thirty (30) days prior to the license expiration. Such request shall describe the work done to date, what work still needs to be completed, and the reason for such extension. The Commissioner may extend the expiration date of this license for a period of up to one year, in order for the Licensee to complete the authorized activities. It shall be at the Commissioner's sole discretion to grant or deny such request. No more than three (3) one-year extensions will be granted under this license.

**18. Compliance Certification.** Not later than 90 days after completion of the authorized work, the Licensee shall prepare and submit to [DEEP.LWRDRegulatory@ct.gov](mailto:DEEP.LWRDRegulatory@ct.gov), the attached Compliance Certification Form. Such Compliance Certification shall be completed, signed, and sealed by the Licensee and a Connecticut Licensed Design Professional. If non-compliance is indicated on the form, or the Commissioner has reason to believe the activities and/or structures were conducted in non-compliance with the license, the Commissioner may require the Licensee to submit as-built plans as a condition of this license.

**19. Maintenance.** The Licensee shall maintain all authorized structures or work in optimal condition or shall remove such structures or facility and restore the affected waters to their pre-work condition. Any such maintenance or removal activity shall be conducted in accordance with applicable law and any additional approvals required by law.

**20. No Work After License Expiration.** Work conducted after the license expiration date is a violation of the license and may subject the licensee to enforcement action, including penalties, as provided by law.

**21. License Transfer.** The license is not transferable without prior written authorization of the Commissioner. A request to transfer a license shall be submitted in writing and shall describe the proposed transfer and the reason for such transfer. The Licensee's obligations under the license shall not be affected by the passage of title to the license site to any other person or municipality until such time as a transfer is approved by the Commissioner.

**22. Document Submission.** Any document required to be submitted to the Commissioner under the license or any contact required to be made with the Commissioner shall, unless otherwise specified in writing by the Commissioner, be directed to:

[DEEP.LWRDRegulatory@ct.gov](mailto:DEEP.LWRDRegulatory@ct.gov) or

Regulatory Section  
Land & Water Resources Division  
Department of Energy and Environmental Protection  
79 Elm Street  
Hartford, Connecticut 06106-5127  
860-424-3019

- 23. Date of Document Submission.** The date of submission to the Commissioner of any document required by the license shall be the date such document is received by the Commissioner. The date of any notice by the Commissioner under the license, including but not limited to notice of approval or disapproval of any document or other action, shall be the date such notice is personally delivered or the date three (3) days after it is mailed by the Commissioner, whichever is earlier. Except as otherwise specified in the license, the word “day” as used in the license means calendar day. Any document or action which is required by the license to be submitted or performed by a date which falls on a Saturday, Sunday or a Connecticut or federal holiday shall be submitted or performed on or before the next day which is not a Saturday, Sunday, or a Connecticut or federal holiday.
- 24. Certification of Documents.** Any document, including but not limited to any notice, which is required to be submitted to the Commissioner under the license shall be signed by the Licensee and by the individual or individuals responsible for actually preparing such document, each of whom shall certify in writing as follows: “I have personally examined and am familiar with the information submitted in this document and all attachments and certify that based on reasonable investigation, including my inquiry of those individuals responsible for obtaining the information, the submitted information is true, accurate and complete to the best of my knowledge and belief, and I understand that any false statement made in this document or its attachments may be punishable as a criminal offense.”
- 25. Accuracy of Documentation.** In evaluating the application for the license, the Commissioner has relied on information and data provided by the Licensee and on the Licensee’s representations concerning site conditions, design specifications and the proposed work, including but not limited to representations concerning the commercial, public or private nature of the work or structures, the water-dependency of said work or structures, its availability for access by the general public, and the ownership of regulated structures or filled areas. If such information proves to be false, deceptive, incomplete or inaccurate, the license may be modified, suspended or revoked, and any unauthorized activities may be subject to enforcement action.
- 26. Limits of Liability.** In granting the license, the Commissioner has relied on all representations of the Licensee, including information and data provided in support of the Licensee’s application. Neither the Licensee’s representations nor the issuance of the license shall constitute an assurance by the Commissioner as to the structural integrity, the engineering feasibility or the efficacy of such design.
- 27. Reporting of Violations.** In the event that the Licensee becomes aware that they did not or may not comply, or did not or may not comply on time, with any provision of this license or of any document incorporated into the license, the Licensee shall immediately notify the

agency contact specified within the license and shall take all reasonable steps to ensure that any noncompliance or delay is avoided or, if unavoidable, is minimized to the greatest extent possible. In so notifying the agency contact, the Licensee shall provide, for the agency's review and written approval, a report including the following information:

- a. the provision(s) of the license that has been violated;
- b. the date and time the violation(s) was first observed and by whom;
- c. the cause of the violation(s), if known;
- d. if the violation(s) has ceased, the duration of the violation(s) and the exact date(s) and times(s) it was corrected;
- e. if the violation(s) has not ceased, the anticipated date when it will be corrected;
- f. steps taken and steps planned to prevent a reoccurrence of the violation(s) and the date(s) such steps were implemented or will be implemented; and
- g. the signatures of the Licensee and of the individual(s) responsible for actually preparing such report.

If the violation occurs outside of normal business hours, the Licensee shall contact the Department of Energy and Environmental Protection Emergency Dispatch at 860-424-3333. The Licensee shall comply with any dates which may be approved in writing by the Commissioner.

- 28. Revocation/Suspension/Modification.** The license may be revoked, suspended, or modified in accordance with applicable law.
- 29. Other Required Approvals.** License issuance does not relieve the Licensee of their obligations to obtain any other approvals required by applicable federal, state and local law.
- 30. Rights.** The license is subject to and does not derogate any present or future property rights or powers of the State of Connecticut, and conveys no property rights in real estate or material nor any exclusive privileges, and is further subject to any and all public and private rights and to any federal, state or local laws or regulations pertinent to the property or activity affected hereby.
- 31. Condition Conflicts.** In the case where a project specific special condition listed on the license differs from, or conflicts with, one of the general conditions listed herein, the project specific special condition language shall prevail. It is the licensee's responsibility to contact the agency contact person listed on the license for clarification if needed prior to conducting any further regulated activities.

August 7, 2023

Ryan Apanovitch  
AECOM Technical Services, Inc.  
500 Enterprise Drive  
Rocky Hill, CT 06067  
[Ryan.apanovitch@aecom.com](mailto:Ryan.apanovitch@aecom.com)

**Project:** In-Kind Eagle Landing Fishing Pier Replacement as Part of Mitigation for Connecticut River Amtrak Bridge (Old Lyme and Lyme) in Eagle Landing State Park at 14 Little Meadow Road in Haddam, Connecticut  
NDDB Portal Filing No.: 98663  
**NDDB Determination No.:** 202305135  
**Expiration Date:** August 7, 2025

Dear Ryan Apanovitch,

According to our records, the following State-listed species (RCSA Sec. 26-306) have been documented in close proximity and may occur within the proposed project area for the In-Kind Eagle Landing Fishing Pier Replacement as Part of Mitigation for Connecticut River Amtrak Bridge (Old Lyme and Lyme) in Eagle Landing State Park at 14 Little Meadow Road in Haddam:

#### Reptiles and Amphibians

- Atlantic coast leopard Frog (*Rana kaufauldii*) Protection Status: \*Proposed as Endangered
- Eastern Box Turtle (*Terrapene carolina carolina*) Protection Status: State Special Concern
- Mudpuppy (*Necturus maculosus*) Protection Status: State Special Concern

#### Dragonfly

- Riverine clubtail (*Stylurus amnicola*) Protection Status: State Threatened
- Cobra clubtail (*Gomphus vastus*) Protection Status: State Threatened

#### Tiger Beetle

- Hairy-necked tiger beetle (*Cincindela hirticollis*) Protection Status: State Special Concern

#### Freshwater Mussel and Snail

- Eastern pondmussel (*Ligumia nasuta*) Protection Status: State Special Concern
- Tidewater mucket (*Leptodea ochracea*) Protection Status: State Special Concern
- Woodland pondsnail (*Stagnicola catascopium*) Protection Status: State Special Concern

#### Fish

- Shortnose sturgeon (*Acipenser brevirostrum*) Protection Status: Federal and State Endangered
- Atlantic sturgeon (*Acipenser oxyrinchus oxyrinchus*) Protection Status: Federal and State Endangered
- Blueback herring (*Alosa aestivalis*) Protection Status: State Special Concern

#### **Protection for State Listed Fish Species**

Please be advised that a DEEP Fisheries Biologist will review the permit applications you may submit to DEEP regulatory programs to determine if your project could adversely affect list fish species. DEEP Fisheries Biologists are routinely involved in pre-application consultations with regulatory staff and applicants in order to identify potential fisheries issues and work with applicants to mitigate negative effects, including to endangered species. If you have not already talked with a Fisheries Biologist about your project, you may contact the Permit Analyst



assigned to process your application for further information, including the contact information for the Fisheries Biologist assigned to review your application.

### **Protection for Tiger Beetle**

The hairy-necked tiger beetle species occupies sandy soils with open patches of xeric (dry), loose shifting sands, without water that are sparsely vegetated.

To avoid impact to these species:

- Avoid impact to sandy areas of the project property.
- Outside of area of impact- apply management efforts that would preserve, maintain, or restore sandy habitat with patches of open sand and areas of sparse vegetation

### **Protection for Dragonfly Species**

The Riverine clubtail and Cobra clubtail require trees along the river/brook, especially tree stumps above the water line to provide important emergence sites for the larvae to crawl on to and turn into adults. The adults spend the majority of their lives in the tree canopy. The aquatic nymph stage requires fine sand deposits. Activities that alter the physical or chemical nature of the aquatic habitat, cause siltation or any source of pollution will be detrimental. Avoid disturbing riverbed or removing riparian vegetation. The emergence and flight period for this species occurs primarily between June 5- July 31.

You will need to develop a protection plan designed to minimize adverse effects on the listed dragonfly in this location. This plan should be developed by an invertebrate biologist specializing in dragonflies. The Wildlife Division does not maintain a list of invertebrate biologists in the state. The plan must be sent to the NDDDB Program ([deep.nddbrequest@ct.gov](mailto:deep.nddbrequest@ct.gov)) before any in-water work may begin. Once you settle on a dragonfly expert, please let our program know.

The dragonfly management plan must include:

- a. Anticipated impacts to dragonflies
- b. Planned mitigation or management practices that will be employed
- c. Habitat descriptions
- d. Statement/resume giving the biologist's qualifications

**Incomplete reports or unqualified biologists may not be accepted.**

The following general considerations will benefit these species:

- Adhere strictly to water quality standards at your project site.
- Pay special attention and address specific monitoring targets for sediment, pH, water temperature, and water levels.
- Avoid changing water level fluctuations of streams and ponds outside of natural conditions and patterns.
- No vegetation should be removed from the 100ft buffer of waterways.
- Disturbance and traffic through shorelines should be minimized. Species sensitive areas should be delineated and protected from disturbance. Disturbance can occur through direct activity along shorelines as well as from indirect wave action from motorboats.
- In the surrounding watershed, turf grass and impervious surface should be minimized. This will protect water quality as well as provide foraging and roosting habitat for adults.
- Take action to reduce non-point source pollution and educate the surrounding community about how to reduce non-point source pollution. More information can be found in our resources for Low Impact Development here: • [www.ct.gov/deep/cwp/view.asp?a=2719&q=464958&deepNav\\_GID=1654](http://www.ct.gov/deep/cwp/view.asp?a=2719&q=464958&deepNav_GID=1654)

Vegetation cover within a kilometer of natal grounds is vital for adult foraging and shelter, especially for females who are driven from natal sites during emergence and flight periods.

- Protect the vegetation within the 100ft wetland buffer to protect water quality and natal site suitability.
- Outside of the 100ft Wetland buffer:
- Substantial vegetation removal should not be conducted during the primary emergence and flight period for this species.

Water quality targets for waterways that contain this species:

- Water levels should not fluctuate beyond natural variation as a result of any water diversions or water discharge
- Turbidity should not increase 8 NTU over background levels

- Maximum induced suspended sediments in any 24-hour period should be less than 25mg/L over background levels
- Induced suspended sediments averaged over 30-day period should be less than 5mg/L over background levels
- Water temperature should not increase 1° C (~1.8°F)
- pH should remain within natural range

Use best management practices available to control storm water runoff from this site both during construction and after construction: Qualified Environmental Inspector(s) shall be on-site daily during the duration of construction, weekly during stabilization, and within 24 hours of storm events with 0.5 inches of precipitation or more to inspect sedimentation and erosion controls to ensure that they continue to function as intended. Stock-piled soils should be situated at least 10 feet from the watercourse and within sedimentation and erosion control devices.

### **Protection for Reptiles and Amphibians**

#### Atlantic coast leopard frog

The State Endangered Atlantic coast leopard frog was recently discovered in Connecticut and is thought to have declined precipitously in New York, including vanishing from Long Island. A handful of populations remain in the lower Hudson Valley and on Staten Island. Loss and fragmentation of wetlands and the expansion of the invasive *Phragmites australis* are all thought to be threats to the Atlantic coastal species. This frog occurs in open habitats, including grasslands, wet meadow, grassy edges, shallow wetlands and clear, slow-moving ditches. In summer they use grassy areas adjacent to breeding habitat and are rarely found far from water.

#### Mudpuppy

In Connecticut the mudpuppy is the largest and only fully aquatic salamander found in Connecticut. The mudpuppy occurs in a wide range of water conditions, including rivers and drainage ditches. In Connecticut, it is mainly found in deeper waters of the Connecticut and Housatonic Rivers and associated drainages. Mudpuppies feed on fish and their eggs, crayfish, aquatic insects and larvae, mollusks, snails, worms, spiders, plant material, and an occasional salamander. They are eaten by fish, turtles, herons, and water snakes. Work within your community to help keep Connecticut's water resources free of siltation and pollution.

#### Eastern box turtles

State Special Concern Eastern box turtle inhabits a variety of habitats, including woodlands, field edges, thickets, marshes, bogs, and stream banks. Typically, however, box turtles are found in well-drained forest bottomlands and a matrix of open deciduous forests, early successional habitat, fields, gravel pits, and or powerlines.

You will need to develop a protection plan designed to minimize adverse effects on the listed reptiles and amphibians in this location. This plan should be developed by a herpetologist **with extensive experience in Connecticut with the State Endangered Atlantic coast leopard frog**. The Wildlife Division does not maintain a list of herpetologists in the state. The protection plan must be sent to the NDDDB Program ([deep.nddbrequest@ct.gov](mailto:deep.nddbrequest@ct.gov)) before any work may begin. Once you settle on a herpetologist with extensive experience in Connecticut with the Atlantic coast leopard frog, please let our program know who will be doing the work for concurrence.

The reptile and amphibian management plan must include:

- a. Anticipated impacts to Atlantic coast leopard frog, Eastern box turtle and Mudpuppy at this project site.
- b. Planned mitigation or management practices that will be employed to protect all state listed species.
- c. Habitat descriptions
- d. Statement/resume giving the biologist's qualifications

**Incomplete reports or unqualified herpetologists may not be accepted.**

#### Protection for Freshwater Mussels and Snail

**You will need to develop a freshwater mussel management plan designed to minimize adverse effects on the listed freshwater mussels and state listed snail in this location.** This plan should be developed by an invertebrate biologist specializing in freshwater mussels. The Wildlife Division does not maintain a list of invertebrate biologists

in the state. A DEEP permit will be required by the biologist to conduct mitigation work; you should ask if your biologist has one. Be aware that if biological surveys are required, they will need to be conducted during the active season (usually between May 1- September 30) and this may affect the timing of your project. The plan must be sent to the NDDB Program ([deep.nddbrequest@ct.gov](mailto:deep.nddbrequest@ct.gov)) before any in-water work may begin. Once you settle on an invertebrate freshwater mussel and snail expert, please let our program, please let our program know who will be doing the work for concurrence.

The mussel management plan must include:

- a. Anticipated impacts to mussels
- b. Planned mitigation or management practices that will be employed to protect/conserves the freshwater mussels and snails.
- c. Habitat descriptions.
- d. Statement/resume giving the biologist's qualifications.

**Incomplete reports or unqualified biologists may not be accepted.**

This determination is valid for two years and will expire on August 4, 2025.

Natural Diversity Database information includes all information regarding critical biological resources available to us at the time of the request. This information is a compilation of data collected over the years by the Department of Energy and Environmental Protection's Bureau of Natural Resources and cooperating units of DEEP, independent conservation groups, and the scientific community. This information is not necessarily the result of comprehensive or site-specific field investigations. Consultations with the NDDB should not be substituted for on-site surveys required for environmental assessments. Current research projects and new contributors continue to identify additional populations of species and locations of habitats of concern, as well as enhance existing data. Such new information is incorporated in the NDDB as it becomes available.

Please contact me if you have any questions ([deep.nddrequest@ct.gov](mailto:deep.nddrequest@ct.gov)). Thank you for consulting with the Natural Diversity Data Base and continuing to work with us to protect State-listed species.

Sincerely,

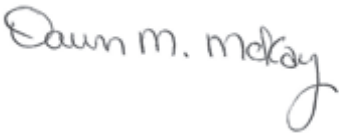
A handwritten signature in cursive script that reads "Dawn M. McKay".

Dawn M. McKay  
Environmental Analyst 3

# Amtrak®

## REPLACEMENT OF MB 106.89 OVER CONNECTICUT RIVER OLD SAYBROOK, CONNECTICUT EAGLE LANDING FISHING PIER RECONSTRUCTION FOR MITIGATION HADDAM, CONNECTICUT

# ENVIRONMENTAL AND PERMIT PLANS

### INDEX OF DRAWINGS

SHEET NO.	DESCRIPTION	DRAWING NO.
1	TITLE SHEET	TTL-01
2	EAGLE LANDING FISHING PIER DEMOLITION	EL-01
3	EAGLE LANDING FISHING PIER PROPOSED PLAN	EL-02
4	EAGLE LANDING ESC PLAN	EL-03
5	EAGLE LANDING TYPICAL SECTIONS	EL-04
6	EAGLE LANDING FISHING PIER ELEVATIONS	EL-05
7	EAGLE LANDING — STATE IMPACT PLAN	STE-1
8	EAGLE LANDING — FEDERAL IMPACT PLAN	FED-1
9	EAGLE LANDING — FEMA IMPACT PLAN	FEMA-1
10	EAGLE LANDING — FEMA IMPACT ELEVATION	FEMA-2
11	EAGLE LANDING — STAGING PLAN	STG-1

#### GENERAL NOTES

- THESE PLANS ARE NOT FOR CONSTRUCTION AND ARE INTENDED ONLY FOR ENVIRONMENTAL PERMITTING PURPOSES. THESE PLANS HOLD THE CONTRACTOR RESPONSIBLE FOR OBTAINING ALL NECESSARY PERMITS, DETAILED PLANIMETRIC INFORMATION AND PAYMENT, REFER TO THE APPLICABLE CONTRACT DOCUMENTS.
- AMTRAK WILL ONLY SUBMIT REVISIONS TO CDEEP AND USACE FOR CHANGES TO THE DESIGN THAT WILL AFFECT REGULATED AREAS.
- THE HORIZONTAL CONTROLS REFERENCE THE NORTH AMERICAN DATUM OF 1983 (NAD83) AND THE CONNECTICUT STATE PLANE COORDINATE SYSTEM. THE VERTICAL DATUM REFERENCE THE NORTH AMERICAN VERTICAL DATUM OF 1988 (NAV888).
- ALL CONSTRUCTION ACTIVITIES WILL BE CONDUCTED IN ACCORDANCE WITH THE CDOT STANDARD SPECIFICATIONS FOR ROADS, BRIDGES, FACILITIES AND INCIDENTAL CONSTRUCTION, FORM 818, SECTION 1.10 AND WILL ALSO FOLLOW REQUIRED BEST MANAGEMENT PRACTICES (BMPs) AND SEDIMENT AND EROSION CONTROL MEASURES IN ACCORDANCE WITH THE CONSTRUCTION EROSION CONTROL GUIDELINES AND THE 2004 STORMWATER QUALITY MANUAL.



LOCATION PLAN



PROJECT VICINITY MAP  
SCALE: 1"=24000'

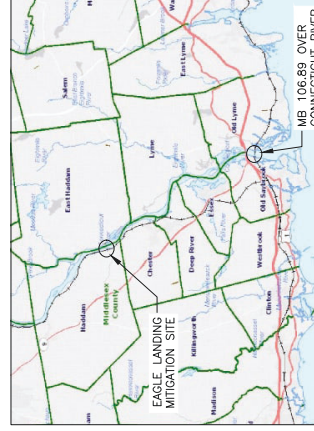

MITIGATION VICINITY MAP  
SCALE: 1"=24000'

No.	Revisions	DATE	BY

**Amtrak®**

This material is owned by Amtrak and is the property of Amtrak. It is loaned to the contractor for use in the performance of the contract. It is not to be used for any other purpose without the written consent of Amtrak. Amtrak and the Amtrak logo are registered trademarks of Amtrak. All other marks are the property of their respective owners. © 2014 Amtrak. All rights reserved.

Office of Chief Engineer  
**STRUCTURES**  
30th Street Station, 20th and 21st Streets, Philadelphia, PA 19104

Approved: \_\_\_\_\_  
Date: \_\_\_\_\_

**HSH** | **HARBESTY & HANOVER, LLC**  
ENGINEERING  
New York, NY 10036

Project Code: JXXX-XX	Sheet No. OF
WBS: 00000	OF
DESIGNED: _____ DRAWN: _____ CHECKED: _____ DATE: _____	
TITLE SHEET	
Dwg No. <b>TTL-01</b>	

**NOTES:**

1. REFER TO DWG. NO. FL-01 FOR GENERAL FISHING PIER NOTES.
2. DIMENSIONS IN THIS PLAN SET INCLUDING BUT NOT LIMITED TO TOP OF BANK LOCATION, EXISTING PIER DIMENSIONS, AND LIMITS OF PROPOSED PIER REPLACEMENT SHOWN ARE APPROXIMATE AND SHALL BE VERIFIED BY THE CONTRACTOR PRIOR TO PERFORMING ANY WORK.
3. ALL ELEVATIONS AND DIMENSIONS TO BE FIELD VERIFIED PRIOR TO CONSTRUCTION.

**LEGEND:**  
 EXISTING STRUCTURE TO BE DEMOLISHED

REGULATORY ELEVATIONS	NAVD88	USACE
MEAN LOWER LOW WATER (M.L.L.W.)	-1.3 FT	0.0 FT
MEAN LOW WATER (M.L.W.)	-1.2 FT	0.1 FT
MEAN HIGH WATER (M.H.W.)	1.6 FT	2.9 FT
COASTAL JURISDICTION LINE (C.J.L.)	3.0 FT	4.3 FT
HIGH TIDE LINE (HTLL)	3.2 FT	4.5 FT

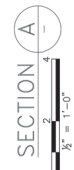
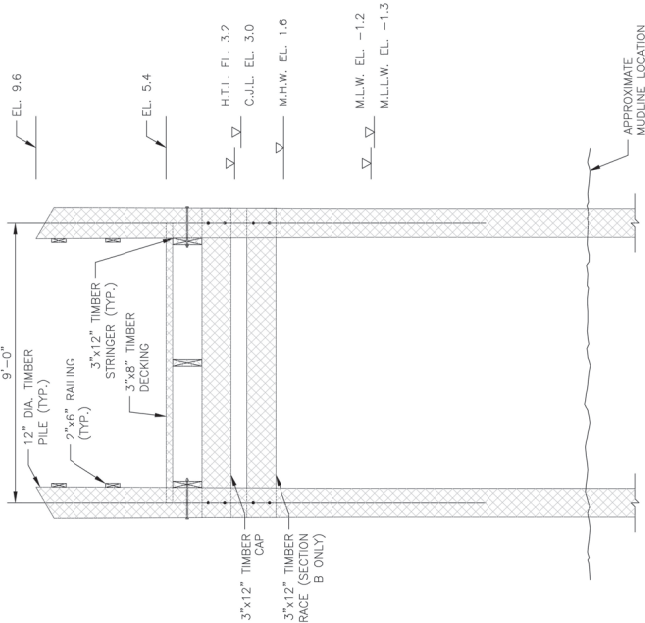
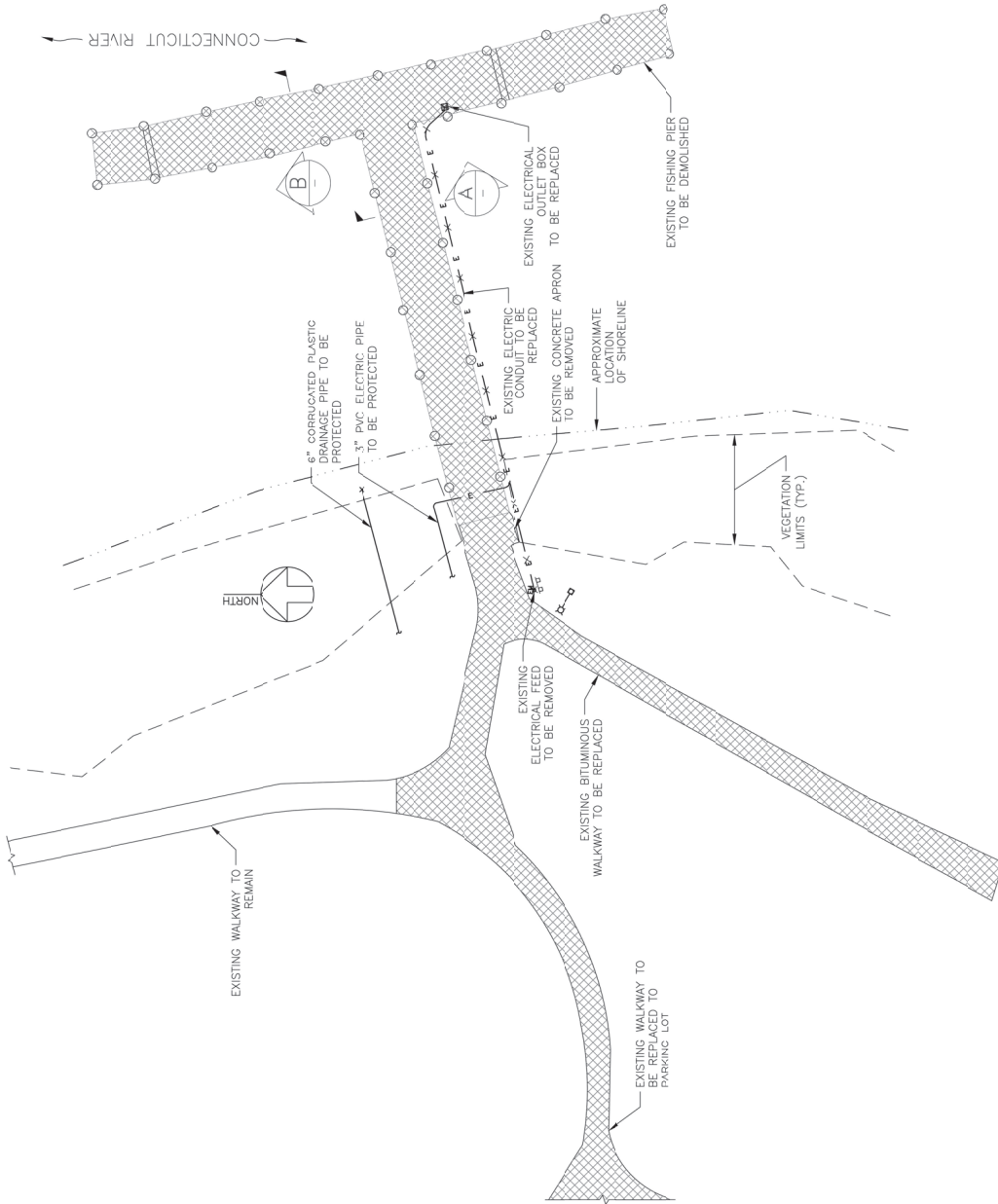

**EXISTING FISHING PIER DEMOLITION PLAN**

 Office of Chief Engineer <b>STRUCTIPS</b> National Railroad Passenger Corporation 300 Street Station, Philadelphia, Pennsylvania 19104	Approved: _____ Date: _____	100% DRAFT SUBMITTAL	CONNECTICUT <b>REPLACEMENT OF MB 106.89                  COVER CONNECTICUT RIVER</b> EAGLE LANDING FISHING PIER DEMOLITION	Project Code: CT106.89 Sheet No.: _____ Dwg No.: <b>EL-01</b>
	Revisions: _____ Date: _____ By: _____	DESIGNED: <b>MF</b> DRAWN: <b>PD</b> CHECKED: <b>MF</b> DATE: 10/13/2023	OLD SAYBROOK HARDESTY & HANOVER LLC ENGINEERING New York, NY 10008	H&H



NOTES:

1. NEW TIMBER PILES SHALL BE INSTALLED A MINIMUM OF 3 FT FROM THE CL OF THE EXISTING PILE. EXISTING PILE LOCATIONS TO BE CONFIRMED IN THE FIELD BY THE CONTRACTOR FOR CORRECTING ANY WORKING DIMENSIONS FOR NEW CONCRETE SIDEWALK SECTION, SEE DWG. NO. F1-03.
2. TIMBER DIAPHRAGMS AT RAILING POST LOCATIONS NOT SHOWN FOR CLARITY.
3. DWG. NO. EL-04 PILES TO CONNECT DIRECTLY TO PILES AND UTILIZE SAME BOLTS AS BRACE CAP TO PILE CONNECTION.
4. FOR TIMBER HANGER CONNECTION DETAIL, SEE DETAIL 4 ON DWG. NO. F1-04.

TIMBER HANGER CONNECTION SEE NOTE 5

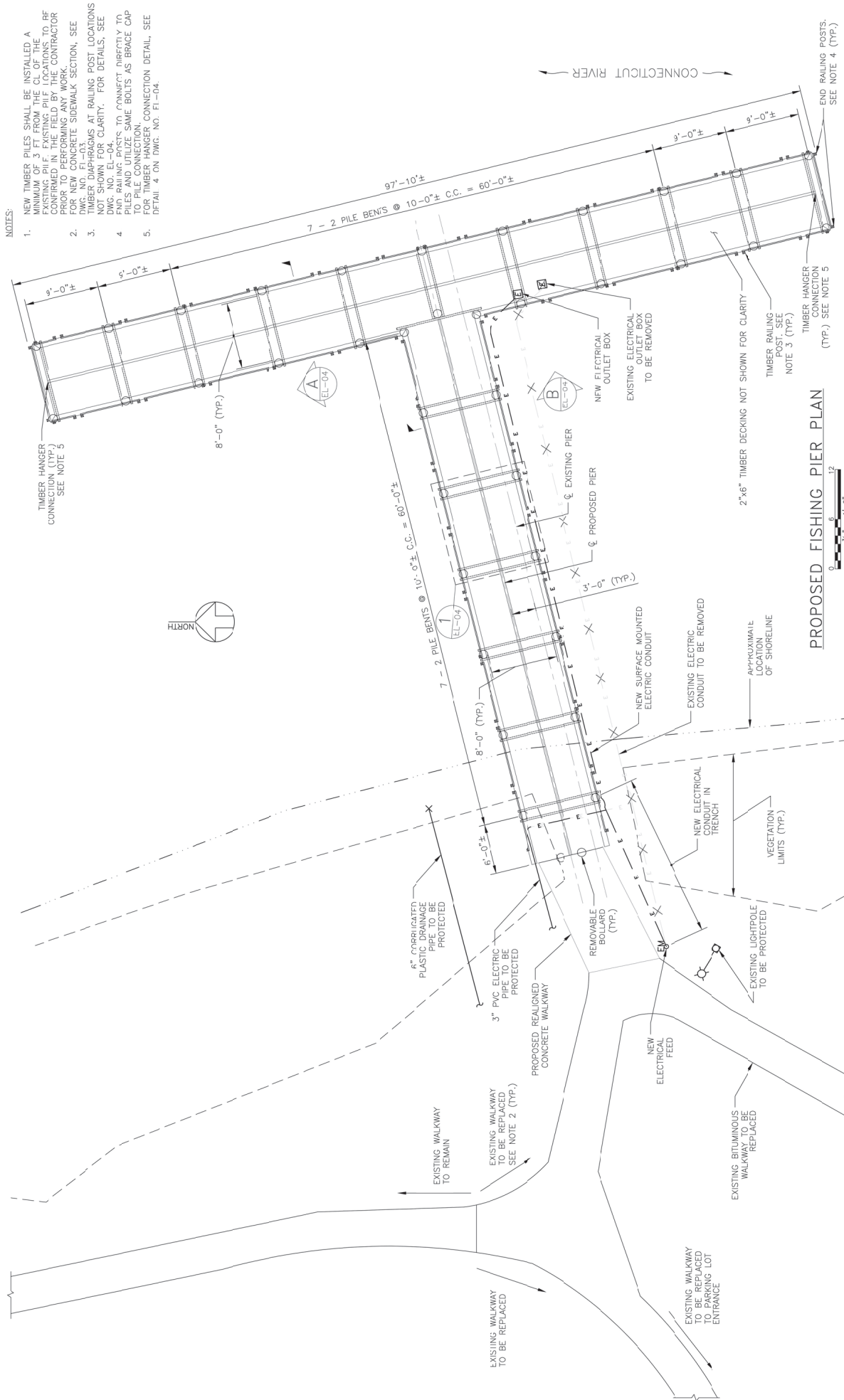

PROPOSED FISHING PIER PLAN

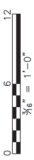

No.	Revisions	Date	By
0	ADDENDUM NO. 5 - NEW SHEET ADDED	10/13/23	IHT
<p>This sheet is issued by and is the property of Amtrak and shall remain in the possession of Amtrak. It is to be used only for the project and location specified on the title block. Any other use, reproduction, or distribution of this sheet without the written permission of Amtrak is prohibited. Amtrak is not responsible for any errors or omissions on this sheet.</p>			
<p><b>Amtrak</b>®</p>			
<p>Office of Chief Engineer  <b>STRUCTURES</b>          National Railroad Passenger Corporation          30th Street Station, Philadelphia, Pennsylvania 19104</p>			
<p>100% DRAFT SUBMITTAL</p>			
<p>Approved: _____ Date: _____</p>			
<p>OLD SAVERBOOK  <b>HARDESTY &amp; HANOVER LLC</b>          ENGINEERING          1000 W. 10th Street          New York, NY 10006</p>			
Designed	Drawn	Checked	Date
EAGLE LANDING FISHING PIER PROPOSED PLAN			10/13/2023
<p>CONNECTICUT          REPLACEMENT OF MB 106.89          OVER CONNECTICUT RIVER</p>			
<p>Project Code: CT106.89</p>			
<p>Sheet No. _____</p>			
<p>Dwg. No. _____</p>			
<p>EL-02</p>			



**EROSION AND SEDIMENTATION CONTROL PLAN NOTES:**

1. EROSION AND SEDIMENTATION CONTROLS MUST BE INSTALLED AND MAINTAINED THROUGHOUT THE GENERAL SITE DISTURBANCE WITHIN THE TRIBUTARY AREAS OF THOSE CONTROLS.
2. AFTER FINAL SITE STABILIZATION HAS BEEN ACHIEVED, EROSION AND SEDIMENTATION CONTROLS MUST BE REMOVED. AREAS DISTURBED DURING REMOVAL OF THE CONTROLS MUST BE STABILIZED.
3. EROSION AND SEDIMENTATION CONTROLS MUST BE PROTECTED FROM DAMAGE BY ALL OPERATIONS OF ALL PARTIES IN ACCORDANCE WITH SPECIFICATION 1339.1.1.11.
4. THE CONTRACTOR WILL BE RESPONSIBLE FOR THE PROPER CONSTRUCTION, STABILIZATION, AND MAINTENANCE OF ALL EROSION AND SEDIMENTATION CONTROLS AND RELATED ITEMS INCLUDED WITHIN THIS PLAN.
5. THE CONTRACTOR MUST DEVELOP, AND HAVE APPROVED BY THE CONNECTICUT DEPARTMENT OF ENVIRONMENTAL PROTECTION, A SEPARATE EROSION AND SEDIMENTATION CONTROL PLAN FOR THE PERMITTED PLAN AREA NOT DETAILED IN THE PERMITTED PLAN, WHETHER LOCATED WITHIN OR OUTSIDE OF THE CONSTRUCTION LIMITS.
6. SHOULD ANY MEASURES CONTAINED WITHIN THIS PLAN PROVE INEFFECTIVE, THE CONTRACTOR SHALL BE RESPONSIBLE FOR ON-SITE FLOWS PRIOR TO DISCHARGE OR OF STABILIZING THE SURFACES IMPACTED BY THE CONTRACTOR. THE CONTRACTOR SHALL ELIMINATE ALL SUCH PROBLEMS PRIOR TO CONTINUING WORK.
7. ON A WEEKLY BASIS AND AFTER EACH STORM EVENT, ALL EROSION AND SEDIMENTATION CONTROLS SHALL BE CHECKED UNTIL THE SITE IS STABILIZED. ALL PREVENTATIVE AND REMEDIAL MAINTENANCE WORK, INCLUDING CLEANOUT, REPAIR, REPLACEMENT, REGRADING, RESEEDING, CLEANOUTING, AND REPAIRS MUST BE PERFORMED IMMEDIATELY.
8. EROSION AND SEDIMENTATION CONTROLS SHALL CONFORM TO THE REQUIREMENTS OF THE "2002 CONNECTICUT GUIDELINES FOR SOIL EROSION AND SEDIMENT CONTROL. CONNECTICUT COUNCIL ON SOIL AND WATER CONSERVATION (GUIDELINES)."
9. SYNTHETIC FILTER FABRIC SHALL BE A PERVIOUS SHEET OF POLYETHYLENE, NYLON, POLYESTER OR ETHYLENE FILAMENTS AND SHALL BE CERTIFIED BY THE MANUFACTURER OR SUPPLIER AS CONFORMING TO THE FOLLOWING REQUIREMENTS:
 

PHYSICAL PROPERTY	REQUIREMENTS
FILTERING EFFICIENCY	75% (MIN.)
TENSILE STRENGTH AT 20% (MAX.) ELONGATION	EXTRA STRENGTH - 50 lbs./lin. in. (MIN.) STANDARD STRENGTH - 30 lbs./lin. in. (MIN.)
FLOW RATE	0.3 gal./sq. ft. (MIN.)
10. PROVIDE FILTER FABRIC ALONG ALL INTERFACE AREAS WITH GROUND CONTACT.
11. SEE CONSTRUCTION GUIDELINES FOR SOIL EROSION AND SEDIMENT CONTROL (2002) FOR ADDITIONAL FILTER FENCE REQUIREMENTS.
12. PROVIDE APPROPRIATE TRANSITION BETWEEN CONSTRUCTION ENTRANCE AND ACCESS PATH, AS REQUIRED
13. ALL WORK SHALL BE PERFORMED IN ACCORDANCE WITH THE REQUIREMENTS OF SECTION 912.043 - ENVIRONMENTAL PROCEDURES AND SECTION 912.000 - EARTH MOVING.

**SIDEWALK NOTES:**

10. DUMMY JOINTS TO BE 4" TYPICAL
11. EXPANSION JOINT TO BE 12" OR AS DIRECTED
12. CROSS SLOPE SHALL BE 1.5% TYPICAL, 2% MAXIMUM

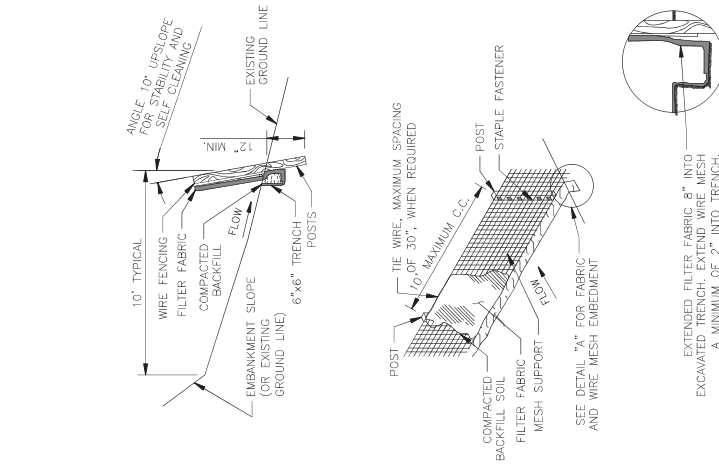

**EROSION CONTROL PLAN**  
SCALE: 1" = 20'

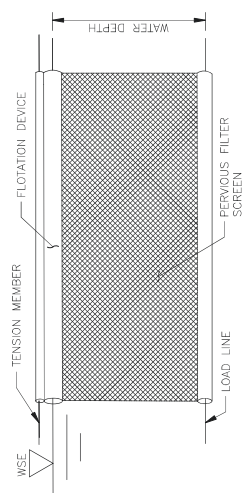

**TURBIDITY CURTAIN DETAIL**  
SCALE: N.T.S.

TURBIDITY CURTAIN TO MEET CDEEP CLASS IV STANDARDS

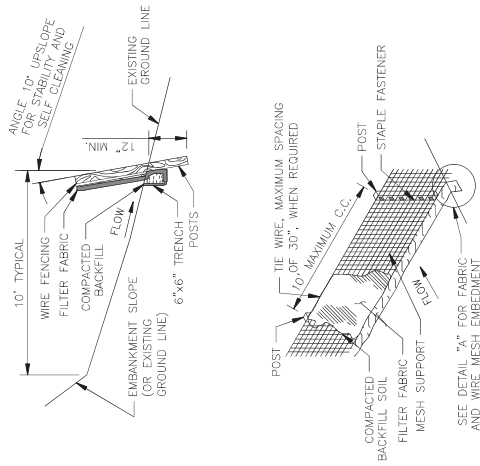

**TEMPORARY SILT FENCE DETAILS**  
SCALE: N.T.S.

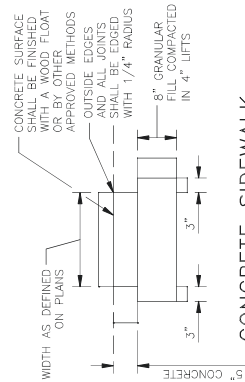

**CONCRETE SIDEWALK**  
SCALE: N.T.S.

		PROJECT CODE: CT10649 SHEET NO. 10/24 OF 10/28 DATE: 10/19/2023	
H&H ENGINEERING 1000 WEST 100TH STREET NEW YORK, NY 10026		REVISIONS:	
DESIGNED: MF	DRAWN: PS	CHECKED: MF	DATE: 10/19/2023
OLD BAYBROOK HARBESTY & HANOVER LLC ENGINEERING 1000 WEST 100TH STREET NEW YORK, NY 10026		PROJECT: REPLACEMENT OF MB 106.89 OVER CONNECTICUT RIVER TITLE: EAGLE LANDING ESC PLAN	
		PROJECT NO.: MB 106.89 SHEET NO.: 10/24 OF 10/28	
Office of Chief Engineer STRUCTURES National Board of Fire Underwriters 30th Street Station, Philadelphia, Pennsylvania 19104		PROJECT NO.: MB 106.89 SHEET NO.: 10/24 OF 10/28	
		PROJECT NO.: MB 106.89 SHEET NO.: 10/24 OF 10/28	
This drawing is prepared for the use of the contractor and is not to be used for any other purpose without the written consent of the contractor. The contractor shall be responsible for obtaining all necessary permits and approvals from the appropriate authorities.		PROJECT NO.: MB 106.89 SHEET NO.: 10/24 OF 10/28	
ADDENDUM NO. 3 - NEW SHEET ADDED		PROJECT NO.: MB 106.89 SHEET NO.: 10/24 OF 10/28	

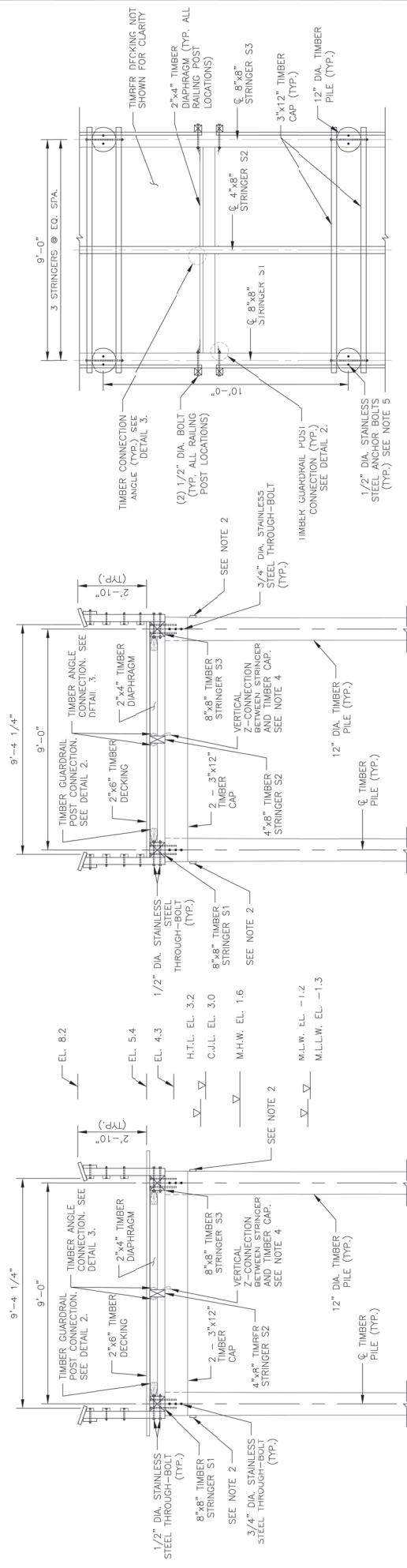

SECTION A  
EL-02  
1" = 1'-0"

SECTION B  
EL-02  
1" = 1'-0"

SECTION C  
EL-02  
1" = 1'-0"

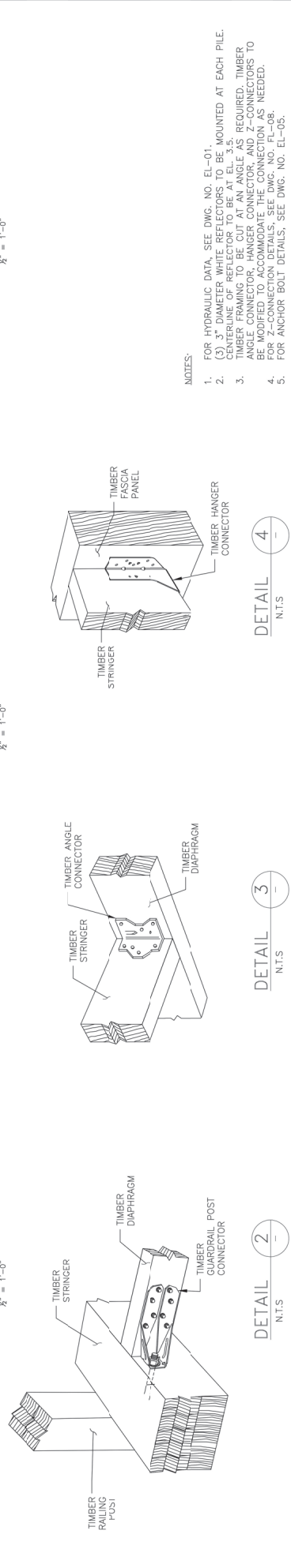

NOTES:  
 1. FOR HYDRAULIC DATA, SEE DWG. NO. EL-01.  
 2. (3) 3" DIAMETER WHITE REFLECTORS TO BE MOUNTED AT EACH PILE. CENTERLINE OF REFLECTOR TO BE AT EL. 3.5.  
 3. REFLECTORS TO BE MOUNTED AT EL. 3.5. REQUIRED, TIMBER ANGLE CONNECTOR, HANGER CONNECTOR AND Z-CONNECTORS TO BE MODIFIED TO ACCOMMODATE THE CONNECTION AS NEEDED.  
 4. FOR Z-CONNECTION DETAILS, SEE DWG. NO. EL-08.  
 5. FOR ANCHOR BOLT DETAILS, SEE DWG. NO. EL-05.

DETAIL 1  
EL-02  
1" = 1'-0"

DETAIL 2  
EL-02  
1" = 1'-0"

DETAIL 3  
EL-02  
1" = 1'-0"

No.	Revisions	Date	By
0	ADDITIONAL NO. 5 - NEW SHEET ADDED	10/13/23	IHT
<p>This sheet is approved by the Chief Engineer and is to be used in accordance with the specifications and drawings of the project. It is the responsibility of the contractor to ensure that the work is done in accordance with the approved drawings and specifications. The contractor shall be responsible for any errors or omissions on this sheet and shall be held liable for any damages resulting therefrom.</p>			
<p>Office of Chief Engineer  <b>STRUCTURES</b>          National Railroad Passenger Corporation          30th Street Station, Philadelphia, Pennsylvania 19104</p>			
<p>Approved: _____</p>			
<p>100% DRAFT SUBMITTAL</p>			
<p>OLD SAVEDBOOK  <b>HARDESTY &amp; HANOVER LLC</b>          ENGINEERING          1000 W. 10th Street          New York, NY 10006</p>			
<p>CONNECTICUT  <b>REPLACEMENT OF MB 106.89          COVER CONNECTICUT RIVER</b></p>			
<p>DESIGNED BY: _____ DRAWN BY: _____ CHECKED BY: _____</p>			
<p>DATE: 10/13/2023</p>			
<p>DWG. NO. <b>EL-04</b></p>			

NOTES:

- NEW TIMBER PILES TO BE DRIVEN TO MINIMUM PILE TIP ELEVATION. PILES TO BE DRIVEN TO BE DETERMINED BY ENR FORMULA.
- PILE HYDRAULIC DATA, SEE DRAWING EL-05.
- (3) 3" DIA. WHITE REFLECTORS TO BE MOUNTED AT EACH PILE. CENTERLINE OF REFLECTOR TO BE AT EL. 3.5.
- #10x2" STAINLESS STEEL WOOD SCREWS TO BE USED TO CONNECT BETWEEN EACH TIMBER DECK PANEL AND EACH TIMBER STRINGER.
- MAXIMUM GAP BETWEEN TIMBER WALKWAY FLOORBOARDS SHALL BE 1/4". MAXIMUM GAP BETWEEN TIMBER WALKWAY FLOORBOARDS SHALL BE 1/4".

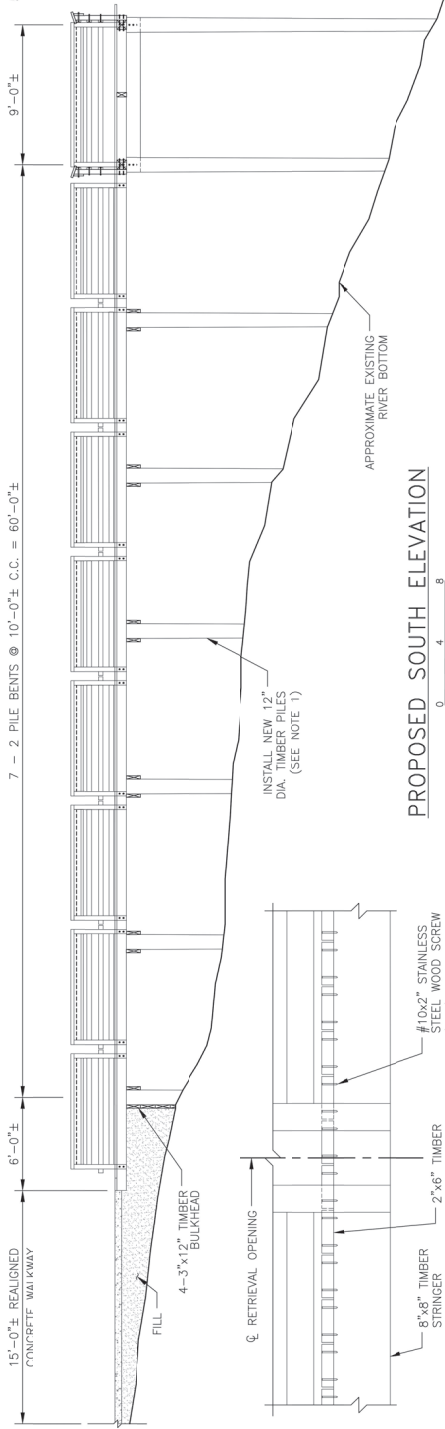

PROPOSED SOUTH ELEVATION

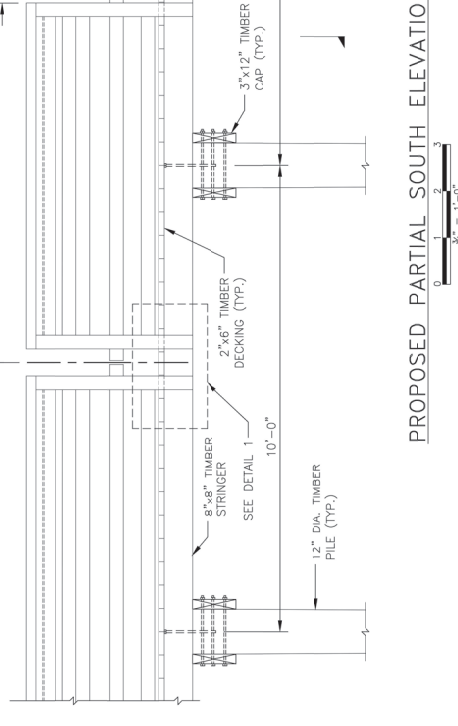

PROPOSED PARTIAL SOUTH ELEVATION



**Amtrak**<sup>®</sup>

Office of Chief Engineer  
STRUCTURES  
National Railroad Passenger Corporation  
300 North Street, Philadelphia, Pennsylvania 19104

No.	Revisions	Date	By
0	ADDENDUM NO. 5 - NEW SHEET ADDED	10/13/23	JHT

10/13/23  
DRAWING FILE NAME: 13  
FILE SCALE & NOTES  
SCALE: 1/4" = 1'-0"  
DATE: 10/13/23

100% DRAFT SUBMITTAL

H&H  
HARBESTY & HANOVER LLC  
ENGINEERING  
New York, NY 10006

DESIGNED BY: [ ]  
DRAWN BY: [ ]  
CHECKED BY: [ ]  
DATE: 10/13/2023

CONNECTICUT  
REPLACEMENT OF MB 106.89  
OVER CONNECTICUT RIVER  
EAGLE LANDING FISHING PIER ELEVATIONS

Project Code: CT106.89  
Sheet No.: [ ]  
Dwg No.: [ ]

EL-05

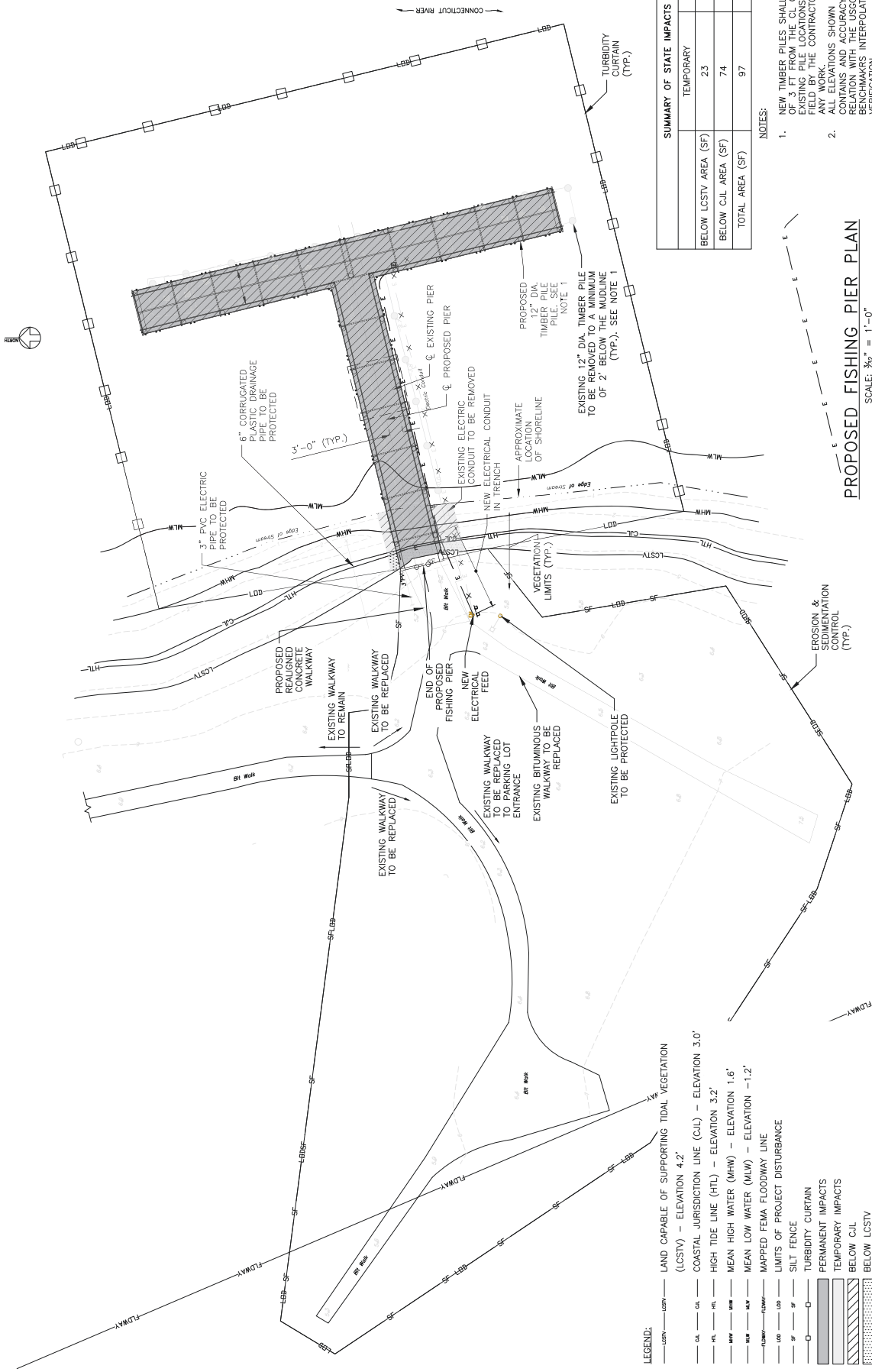

**LEGEND.**

- LCSTV — ELEVATION 4.2'
- CA — COASTAL JURISDICTION LINE (CJL) — ELEVATION 3.0'
- HTL — HIGH TIDE LINE (HTL) — ELEVATION 3.2'
- MHW — MEAN HIGH WATER (MHW) — ELEVATION 1.6'
- MLW — MEAN LOW WATER (MLW) — ELEVATION -1.2'
- FFLW — MAPPED FEMA FLOODWAY LINE
- SF — LIMITS OF PROJECT DISTURBANCE
- S — SILT FENCE
- T — TURBIDITY CURTAIN
- P — PERMANENT IMPACTS
- T — TEMPORARY IMPACTS
- B — BELOW CUL
- B — BELOW LCSTV

**SUMMARY OF STATE IMPACTS**

	TEMPORARY	PERMANENT
BELOW LCSTV AREA (SF)	23	31
BELOW CUL AREA (SF)	74	1,570
TOTAL AREA (SF)	97	1,601

**NOTES:**

- NEW TIMBER PILES SHALL BE INSTALLED A MINIMUM 3' FROM THE CENTERLINE OF EXISTING PILE LOCATIONS TO BE CONFIRMED IN THE FIELD BY THE CONTRACTOR PRIOR TO PERFORMING ANY WORK.
- ALL ELEVATIONS SHOWN ARE APPROXIMATE AND CONTAINS AN ACCURACY OF 0.10' +/- BASED ON BENCHMARK INTERPOLATION AND FIELD VERIFICATION.

**PROPOSED FISHING PIER PLAN**  
SCALE: 3/8" = 1'-0"

<b>Amtrak</b> <small>Amtrak is a service mark of the National Railroad Passenger Corporation, a wholly owned subsidiary of the National Infrastructure Anti-Corruption Center, Inc. Amtrak is a registered trademark of the National Railroad Passenger Corporation. Office of Engineers &amp; Constructors.</small>	Office of Chief Engineer <b>STRUCTURES</b> <small>National Railroad Passenger Corporation 30th Street Station, Philadelphia, Pennsylvania 19104</small>	<b>H&amp;H</b> <small>HARDISTY &amp; HANOVER, LLC ENGINEERING New York, NY 10005</small>	CONNECTICUT <b>REPLACEMENT OF MB 106.89 OVER CONNECTICUT RIVER</b> <b>EAGLE LANDING - STATE IMPACT PLAN</b>	Project Code: CT10689 Sheet No. 1 OF 5 Date: 10/21/2023
DESIGNED BY: <b>WT</b> DRAWN BY: <b>AMA</b> CHECKED BY: <b>BSH</b>		DATE: 10/21/2023		

THE MARK ON EACH SCALE LENGTH INDICATES THE SCALE OF THE ORIGINAL DRAWING.  
 1/32" = 1'-0" (VERTICAL)  
 3/8" = 1'-0" (HORIZONTAL)

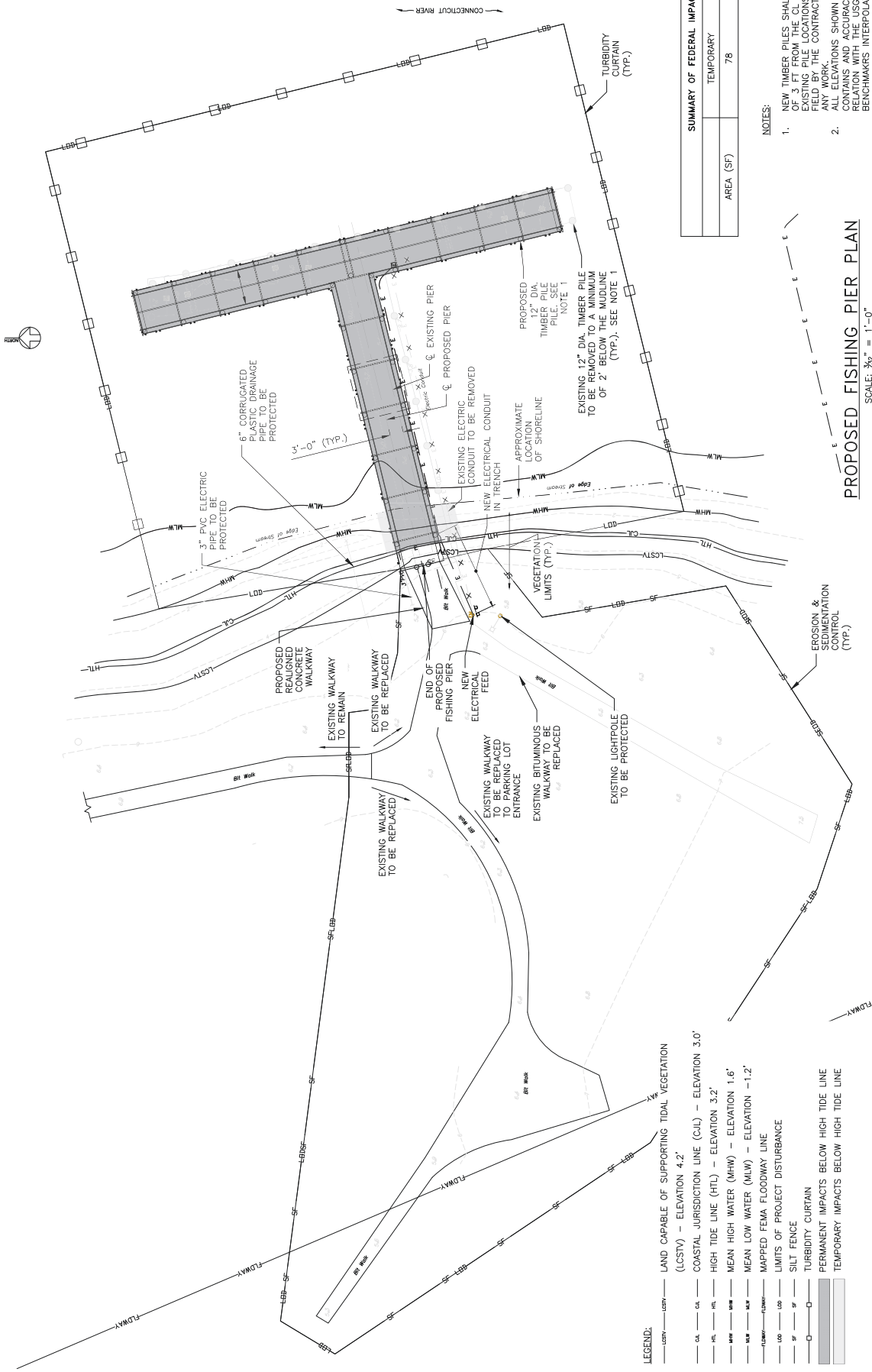

- LEGEND:**
- LCSTV — LAND CAPABLE OF SUPPORTING TIDAL VEGETATION (LCSTV) — ELEVATION 4.2'
  - CA — COASTAL JURISDICTION LINE (CJL) — ELEVATION 3.0'
  - HTL — HIGH TIDE LINE (HTL) — ELEVATION 3.2'
  - MHW — MEAN HIGH WATER (MHW) — ELEVATION 1.6'
  - MLW — MEAN LOW WATER (MLW) — ELEVATION -1.2'
  - FFL — MAPPED FEMA FLOODWAY LINE
  - SF — LIMITS OF PROJECT DISTURBANCE
  - SIF — SILT FENCE
  - T.C. — TURBIDITY CURTAIN
  - P.I. — PERMANENT IMPACTS BELOW HIGH TIDE LINE
  - T.I. — TEMPORARY IMPACTS BELOW HIGH TIDE LINE

SUMMARY OF FEDERAL IMPACTS	
AREA (SF)	PERMANENT
	78
	1,577

- NOTES:**
- NEW TIMBER PILES SHALL BE INSTALLED A MINIMUM OF 3 FT FROM THE CL OF THE EXISTING PILE. EXISTING PILE LOCATIONS TO BE CONFIRMED IN THE FIELD BY THE CONTRACTOR PRIOR TO PERFORMING ANY WORK.
  - ALL ELEVATIONS SHOWN ARE APPROXIMATE AND CONTAINS AND ACCURACY OF 0.10' +/- BASED ON RELATION WITH THE USGC AND NOAA GAUGE DATA. INTERPOLATION AND FIELD VERIFICATION.

**PROPOSED FISHING PIER PLAN**  
SCALE: 3/8" = 1'-0"

	H&H H&H ENGINEERING 100 West Street New York, NY 10038	PROJECT NO. MB 106.89 SHEET NO. 2 OF 5 DATE 10/21/2023
	DESIGNED BY: [Blank] DRAWN BY: [Blank] CHECKED BY: [Blank]	PROJECT TITLE: REPLACEMENT OF MB 106.89 OVER CONNECTICUT RIVER EAGLE LANDING - FEDERAL IMPACT PLAN
Office of Chief Engineer <b>STRUCTURES</b> National Board of Fire Underwriters 300 Street Station, Philadelphia, Pennsylvania 19104		Amtrak® <small>Amtrak is a registered service mark of the National Railroad Passenger Corporation, a wholly owned subsidiary of the National Infrastructure Anti-Corruption Center, a wholly owned subsidiary of the National Infrastructure Anti-Corruption Center, a wholly owned subsidiary of the National Infrastructure Anti-Corruption Center.</small>

THIS DRAWING IS THE PROPERTY OF H&H ENGINEERING. IT IS TO BE USED ONLY FOR THE PROJECT AND SITE SPECIFICALLY IDENTIFIED HEREON. IT IS NOT TO BE REPRODUCED, COPIED, OR TRANSMITTED IN ANY FORM OR BY ANY MEANS, ELECTRONIC OR MECHANICAL, INCLUDING PHOTOCOPYING, RECORDING, OR BY ANY INFORMATION STORAGE AND RETRIEVAL SYSTEM, WITHOUT THE WRITTEN PERMISSION OF H&H ENGINEERING.







NOTES:

- ALL ELEVATIONS SHOWN ARE APPROXIMATE AND CONTAINS AN ACCURACY OF ± 0.10'. ALL MARKS BASED ON RELATION WITH THE USGC AND NOAA GAUGE BENCHMARKS INTERPOLATION AND FIELD VERIFICATION.
- FLOODPLAIN FEMA 100-YEAR FLOOD LIMITS ARE TO THE WEST OF THE PROJECT SITE LIMIT OF DISTURBANCE.

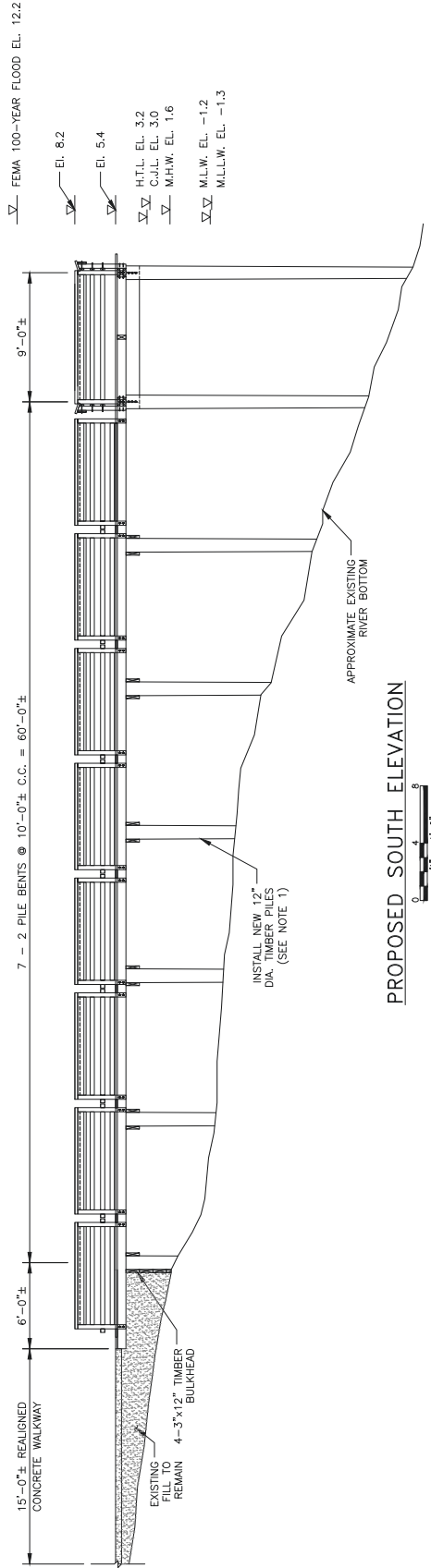

- ▽ FEMA 100-YEAR FLOOD EL. 12.2
- ▽ El. 8.2
- ▽ El. 5.4
- ▽ H.T.L. EL. 3.2
- ▽ C.J.L. EL. 3.0
- ▽ M.H.W. EL. 1.6
- ▽ M.L.W. EL. -1.2
- ▽ M.L.L.W. EL. -1.3

PROPOSED SOUTH ELEVATION

PILE TIP ELEVATION DATA			
SUBSTRUCTURE UNIT	PILE CUTOFF ELEVATION	ESTIMATED TIP ELEVATION	MINIMUM TIP ELEVATION
EAGLE LANDING FISHING PIER	+5.5 FT	-45 FT	-32 FT

OLD DRAWING	CONNECTICUT	PROJECT CODE	CT106.89
HARDESTY & HANOVER, LLC ENGINEERING New York, NY 10036	REPLACEMENT OF MB 106.89 OVER CONNECTICUT RIVER	SHEET NO.	4 OF 5
<b>HSH</b>	EAGLE LANDING - FEMA IMPACT ELEVATION	DATE	10/21/2023
DESIGNED BY	CHECKED BY	DATE	10/21/2023

**Amtrak**  
Amtrak is a registered trademark of the National Railroad Passenger Corporation, a wholly owned subsidiary of the National Transportation Infrastructure Administration. © 2023 Amtrak. All rights reserved.

Office of Chief Engineer  
**STRUCTURES**  
 National Railroad Passenger Corporation  
 300 North Street, Philadelphia, Pennsylvania 19104

DATE: \_\_\_\_\_ BY: \_\_\_\_\_  
 APPROVED: \_\_\_\_\_  
 DATE: \_\_\_\_\_

NO.	REVISIONS	DATE	BY
0	ADDENDUM NO. 1 - NEW SHEET ADDED	10/13/23	LHT

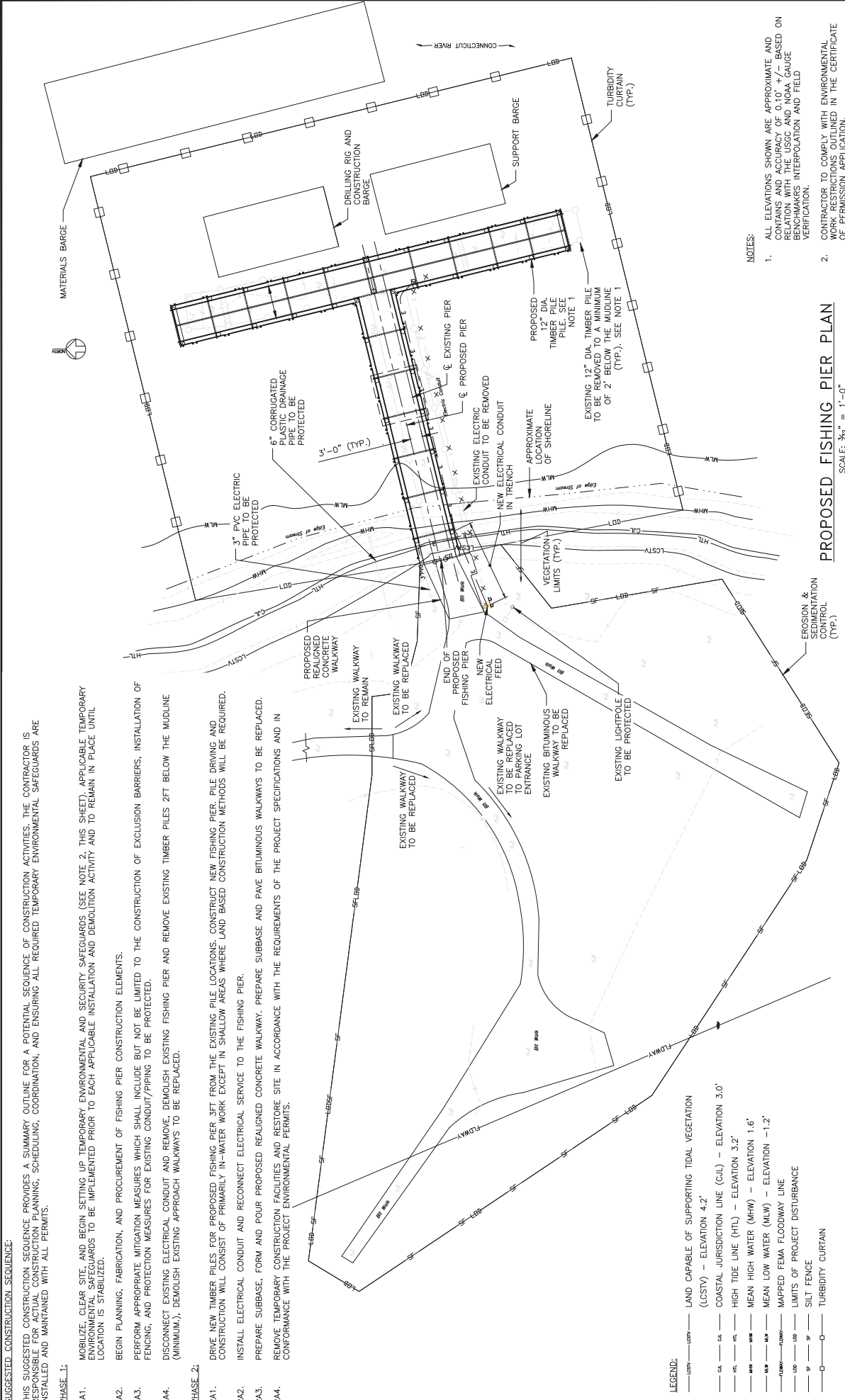

- SUGGESTED CONSTRUCTION SEQUENCE:**  
 THIS SUGGESTED CONSTRUCTION SEQUENCE PROVIDES A SUMMARY OUTLINE FOR A POTENTIAL SEQUENCE OF CONSTRUCTION ACTIVITIES. THE CONTRACTOR IS RESPONSIBLE FOR ACTUAL CONSTRUCTION PLANNING, SCHEDULING, COORDINATION, AND ENSURING ALL REQUIRED TEMPORARY ENVIRONMENTAL SAFEGUARDS ARE INSTALLED AND MAINTAINED WITH ALL PERMITS.
- PHASE 1:**
- 1A1. MOBILIZE, CLEAR SITE, AND BEGIN SETTING UP TEMPORARY ENVIRONMENTAL AND SECURITY SAFEGUARDS (SEE NOTE 2, THIS SHEET). APPLICABLE TEMPORARY ENVIRONMENTAL SAFEGUARDS TO BE IMPLEMENTED PRIOR TO EACH APPLICABLE INSTALLATION AND DEMOLITION ACTIVITY AND TO REMAIN IN PLACE UNTIL LOCATION IS STABILIZED.
  - 1A2. BEGIN PLANNING, FABRICATION, AND PROCUREMENT OF FISHING PIER CONSTRUCTION ELEMENTS.
  - 1A3. PERFORM APPROPRIATE MITIGATION MEASURES WHICH SHALL INCLUDE BUT NOT BE LIMITED TO THE CONSTRUCTION OF EXCLUSION BARRIERS, INSTALLATION OF FENCING, AND PROTECTION MEASURES FOR EXISTING CONDUIT/PIPING TO BE PROTECTED.
  - 1A4. DISCONNECT EXISTING ELECTRICAL CONDUIT AND REMOVE, DEMOLISH EXISTING FISHING PIER AND REMOVE EXISTING TIMBER PILES 2FT BELOW THE MUDLINE (MINIMUM). DEMOLISH EXISTING APPROACH WALKWAYS TO BE REPLACED.
- PHASE 2:**
- 2A1. DRIVE NEW TIMBER PILES FOR PROPOSED FISHING PIER 3FT FROM THE EXISTING PILE LOCATIONS. CONSTRUCT NEW FISHING PIER. PILE DRIVING AND CONSTRUCTION WILL CONSIST OF PRIMARILY IN-WATER WORK EXCEPT IN SHALLOW AREAS WHERE LAND BASED CONSTRUCTION METHODS WILL BE REQUIRED.
  - 2A2. INSTALL ELECTRICAL CONDUIT AND RECONNECT ELECTRICAL SERVICE TO THE FISHING PIER.
  - 2A3. PREPARE SUBBASE, FORM AND POUR PROPOSED REALIGNED CONCRETE WALKWAY. PREPARE SUBBASE AND PAVE BITUMINOUS WALKWAYS TO BE REPLACED.
  - 2A4. REMOVE TEMPORARY CONSTRUCTION FACILITIES AND RESTORE SITE IN ACCORDANCE WITH THE REQUIREMENTS OF THE PROJECT SPECIFICATIONS AND IN CONFORMANCE WITH THE PROJECT ENVIRONMENTAL PERMITS.

- LEGEND:**
- LCSTV — ELEVATION 4.2' — LAND CAPABLE OF SUPPORTING TIDAL VEGETATION
  - CL — COASTAL JURISDICTION LINE (CJL) — ELEVATION 3.0'
  - HTL — HIGH TIDE LINE (HTL) — ELEVATION 3.2'
  - MHW — MEAN HIGH WATER (MHW) — ELEVATION 1.6'
  - MLW — MEAN LOW WATER (MLW) — ELEVATION -1.2'
  - FSD — MAPPED FEMA FLOODWAY LINE
  - L — LIMITS OF PROJECT DISTURBANCE
  - SF — SILT FENCE
  - TC — TURBIDITY CURTAIN

- NOTES:**
1. ALL ELEVATIONS SHOWN ARE APPROXIMATE AND CONTAINS AN ACCURACY OF 0.10' +/- BASED ON RELATION WITH THE USCC AND NOAA GAUGE BENCHMARKS INTERPOLATION AND FIELD VERIFICATION.
  2. CONTRACTOR TO COMPLY WITH ENVIRONMENTAL WORK RESTRICTIONS OUTLINED IN THE CERTIFICATE OF PERMISSION APPLICATION.

**PROPOSED FISHING PIER PLAN**  
 SCALE: 3/8" = 1'-0"

	<b>H&amp;H ENGINEERING</b> 1000 WEST 10TH STREET NEW YORK, NY 10019	CONNECTICUT <b>REPLACEMENT OF MB 106.89          OVER CONNECTICUT RIVER          EAGLE LANDING - STAGING PLAN</b>	Project Code: CT10689 Sheet No. 5 OF 5 Date: 10/21/2023 Drawn: AJA Checked: BSH Design: MF <b>STG-1</b>
<b>Office of Chief Engineer          STRUCTURES</b> National Board of Fire Underwriters 300 North Street, Philadelphia, Pennsylvania 19104		<b>Amtrak®</b> <small>Amtrak is a service mark of the National Railroad Passenger Corporation (d/b/a Amtrak), a not-for-profit corporation. All other marks contained herein are the property of their respective owners. © 2023 Amtrak. All rights reserved. Amtrak is an equal opportunity employer. Amtrak is an equal opportunity employer. Amtrak is an equal opportunity employer.</small>	



**LWRD Work Commencement Form**

**To:** [DEEP.LWRDRegulatory@ct.gov](mailto:DEEP.LWRDRegulatory@ct.gov) or  
Regulatory Section  
Department of Energy and Environmental Protection  
Land & Water Resources Division  
79 Elm Street  
Hartford, CT 06106-5127

**Licensee Name:** CTDEEP State Parks Division c/o Tom Tyler  
**Municipality in which the project is occurring:** Haddam  
**DEEP License No(s):** 202308901-COP

**CONTRACTOR(s):**

# 1 Name: \_\_\_\_\_  
Address: \_\_\_\_\_  
Telephone: \_\_\_\_\_  
E-mail: \_\_\_\_\_

# 2 Name: \_\_\_\_\_  
Address: \_\_\_\_\_  
Telephone: \_\_\_\_\_  
E-mail: \_\_\_\_\_

# 3 Name: \_\_\_\_\_  
Address: \_\_\_\_\_  
Telephone: \_\_\_\_\_  
E-mail: \_\_\_\_\_

Date Contractor(s) received a copy  
of the license and approved plans: \_\_\_\_\_

EXPECTED DATE OF COMMENCEMENT OF WORK: \_\_\_\_\_

EXPECTED DATE OF COMPLETION OF WORK: \_\_\_\_\_

LICENSEE: \_\_\_\_\_  
(Signature) (Date)



## Compliance Certification Form

The following certification must be signed by the licensee working in consultation with a Connecticut-licensed design professional and must be submitted to the address indicated at the end of this form within ninety (90) days of completion of the authorized work.

<p>1. Licensee Name: <u>Tom Tyler, State Parks Division, Connecticut Departments of Energy and Environmental Protection</u></p> <p>DEEP License Number(s): <u>202308901-COP</u></p> <p>Municipality in which project is occurring: <u>Haddam</u></p>	
<p>2. Check one:</p> <p>(a) <input type="checkbox"/> "I certify that the final site conditions and / or structures are in general conformance with the approved site plans". Identify and describe any deviations and attach to this form.</p> <p>(b) <input type="checkbox"/> "The final site conditions and / or structures are not in general conformance with the approved site plans. The enclosed "as-built" plans note the modifications".</p>	
<p>3. "I understand that any false statement in this certification is punishable as a criminal offence under section 53a-157b of the General Statutes and under any other applicable law."</p>	
<p>_____ Signature of Licensee</p>	<p>_____ Date</p>
<p>_____ Name of Licensee (print or type)</p>	
<p>_____ Signature of CT-Licensed Design Professional</p>	<p>_____ Date</p>
<p>_____ Name of CT-Licensed Design Professional (print or type)</p>	
<p>_____ Professional License Number (if applicable)</p>	<p>Affix Stamp Here</p> <div style="border: 1px solid black; width: 150px; height: 100px; margin: 0 auto;"></div>
<ul style="list-style-type: none"> <li>As-built plans shall include: elevations or tidal datums, as applicable, and structures, including any proposed elevation views and cross sections included in the approved license plans. Such as-built plans shall be the original ones and be signed and sealed by an engineer, surveyor or architect, as applicable, who is licensed in the State of Connecticut.</li> <li>The Licensee will be notified by staff of the Land and Water Resources Division (LWRD) if further compliance review is necessary. Lack of response by LWRD staff does not imply compliance.</li> </ul> <p>Submit this completed form to : <a href="mailto:DEEP.LWRDRegulatory@ct.gov">DEEP.LWRDRegulatory@ct.gov</a> or</p> <p><b>Regulatory Section Department of Energy and Environmental Protection Land &amp; Water Resources Division 79 Elm Street Hartford, CT 06106-5127</b></p>	